

Parcels affected - 21

- 084-102-01, 03, 04, 06, 11
- 084-172-07, 09-11
- 084-192-02, 11-13, 16-20
- 084-450-01, 02
- 084-710-03

### Proposed Storey County Land Acquisition

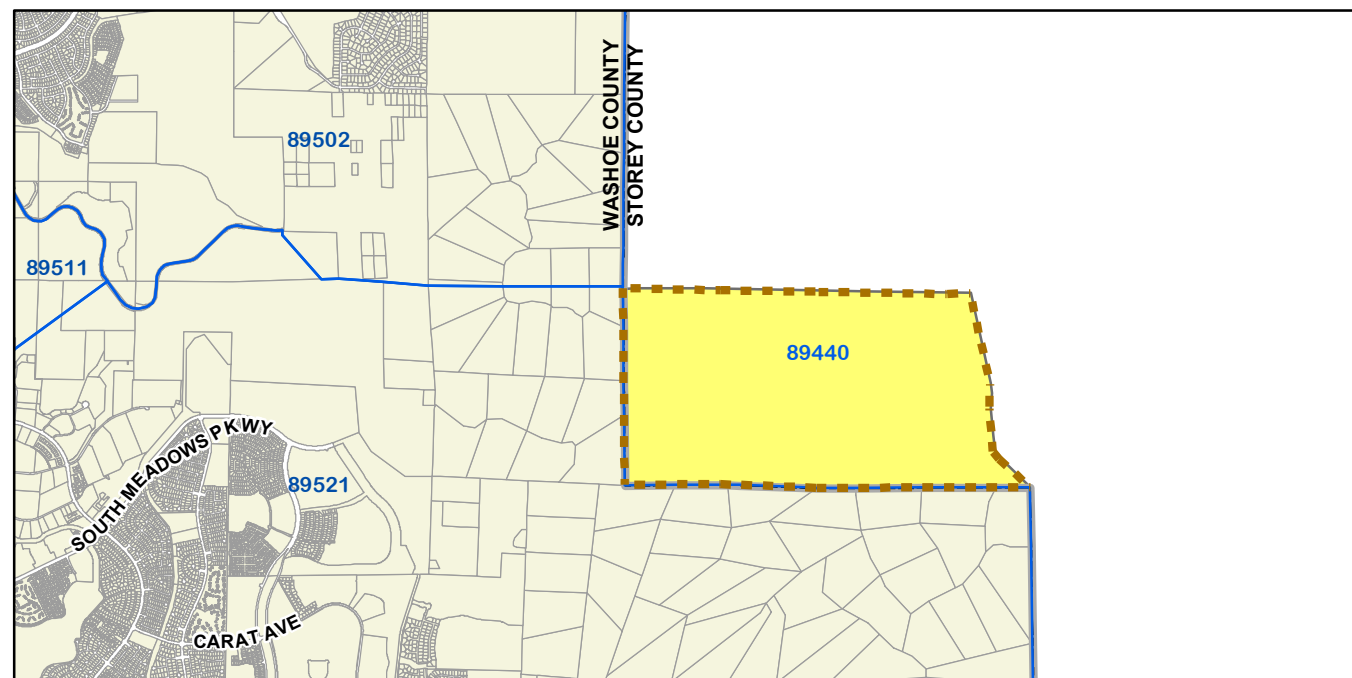

### Proposed Washoe County Land Acquisition

ZipCode Boundary

SOURCE: WASHOE COUNTY TECHNOLOGY SERVICES/REGIONAL SERVICES DIVISION/GIS

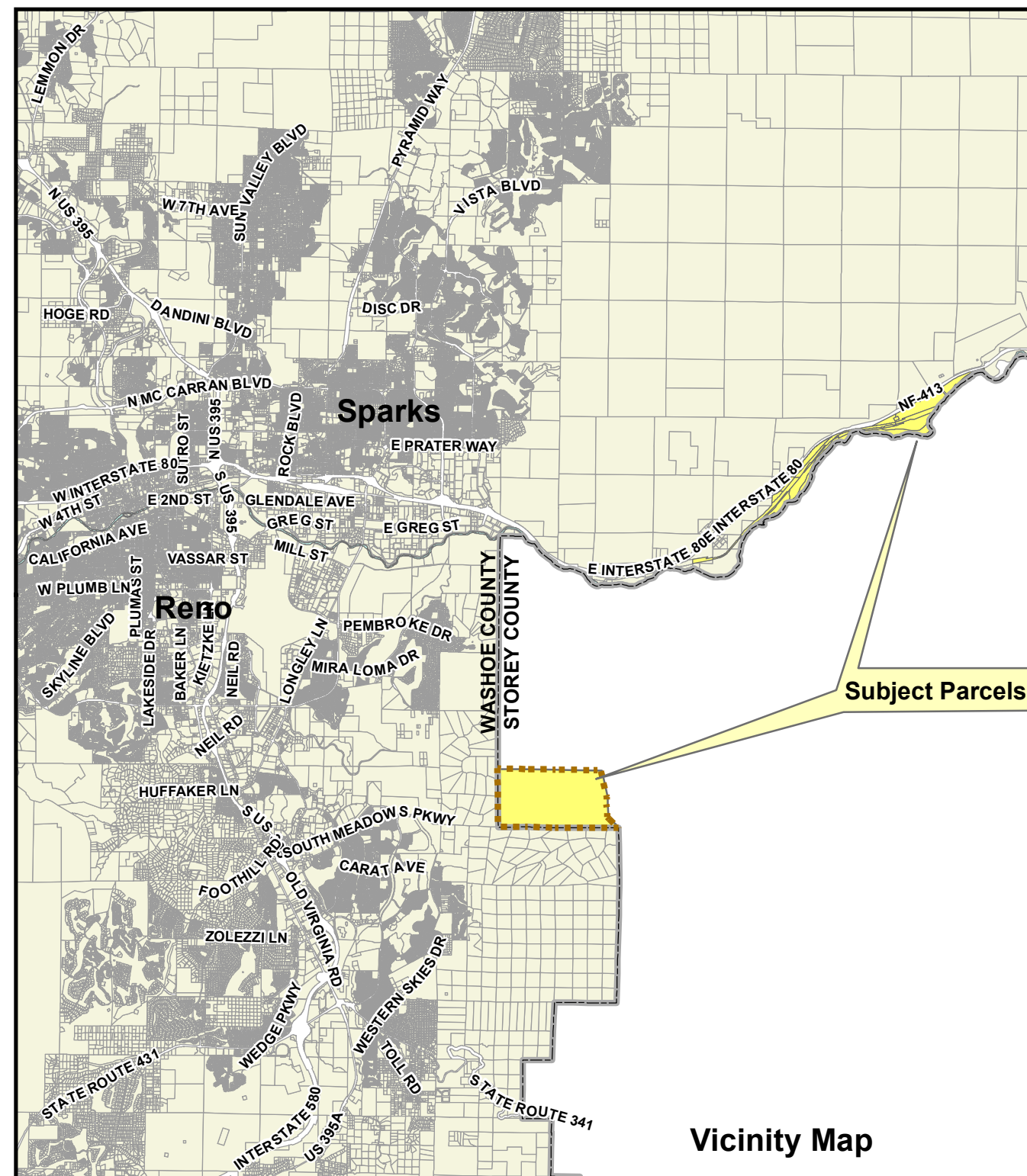

### Vicinity Map

DATE: MARCH 2013

# SB 272



## TECHNOLOGY SERVICES DEPARTMENT

1001 E. Ninth St.  
Reno, NV 89520



NOTE: THE SCALE AND CONFIGURATION OF ALL INFORMATION SHOWN HEREON ARE APPROXIMATE ONLY AND ARE NOT INTENDED AS A GUIDE FOR DESIGN OR SURVEY WORK. REPRODUCTION IS NOT PERMITTED WITHOUT PRIOR WRITTEN PERMISSION FROM THE WASHOE COUNTY TECHNOLOGY SERVICES DEPARTMENT.

\\WCAT\GIS\data\1\publicworks\_misc\BDR840\_March\_2013\_11x17.mxd